

1. Inspect material upon receipt to verify quantity and quality (mounting hardware supplied by installer).
2. If cutting of the aluminum is required, a miter saw with a fine tooth carbide tip blade is recommended.
3. Install aluminum extrusion first. Allow at least 3" of clearance from end of extrusion to inside corners, door/window frames, or other protrusions from wall surface. The clearance is required so the tac•wall® may be inserted in through the end of the extrusion.
4. Attach end caps.

1" tack rail

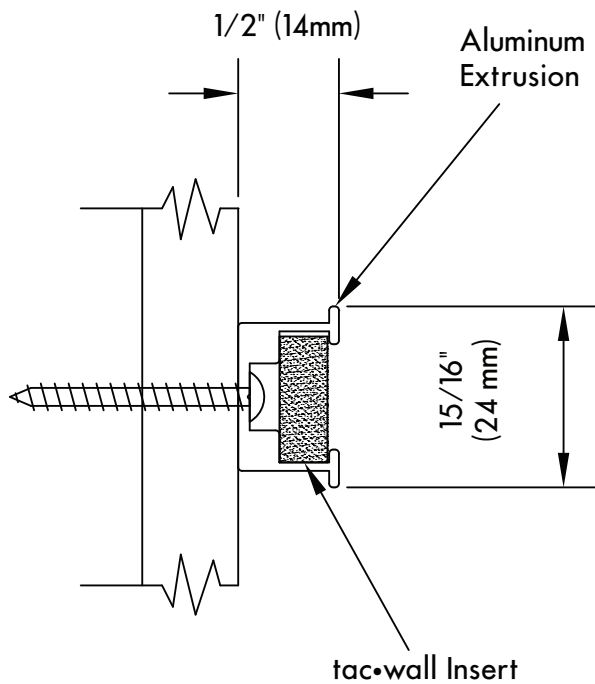

2" tack rail

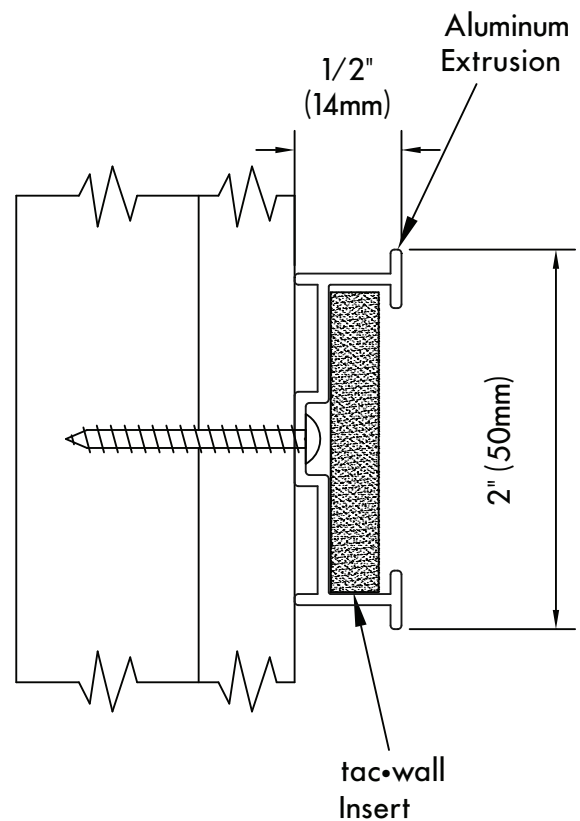

1" and 2" tack rail installation instructions

www.walltalkers.com

walltalkers

a division of RJF International Corporation

3875 Embassy Parkway

Fairlawn, OH 44333

PH: 800.820.9255 • Fax: 330.688.7703

tac•wall® is a registered trademark of RJF International Corp.

7075ATR3I11 10/10